

1 Health marker fixing detail
1 : 20

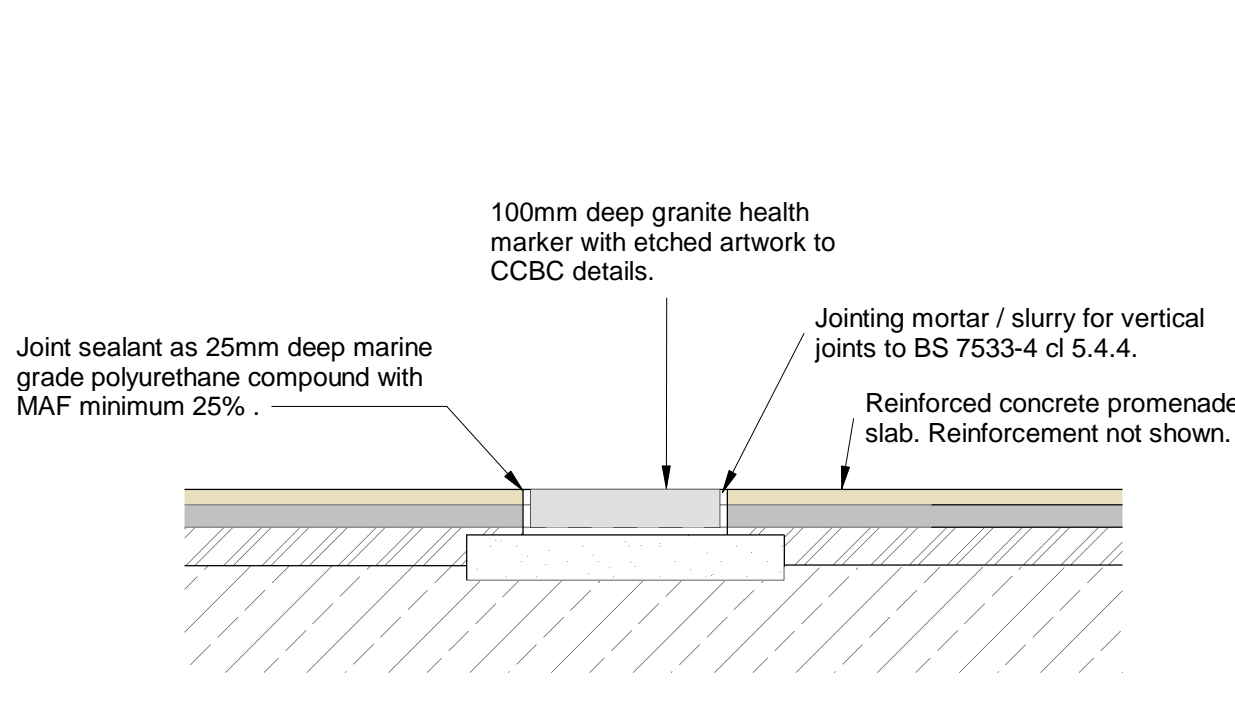

2 Health marker fixing detail - end view
1 : 20

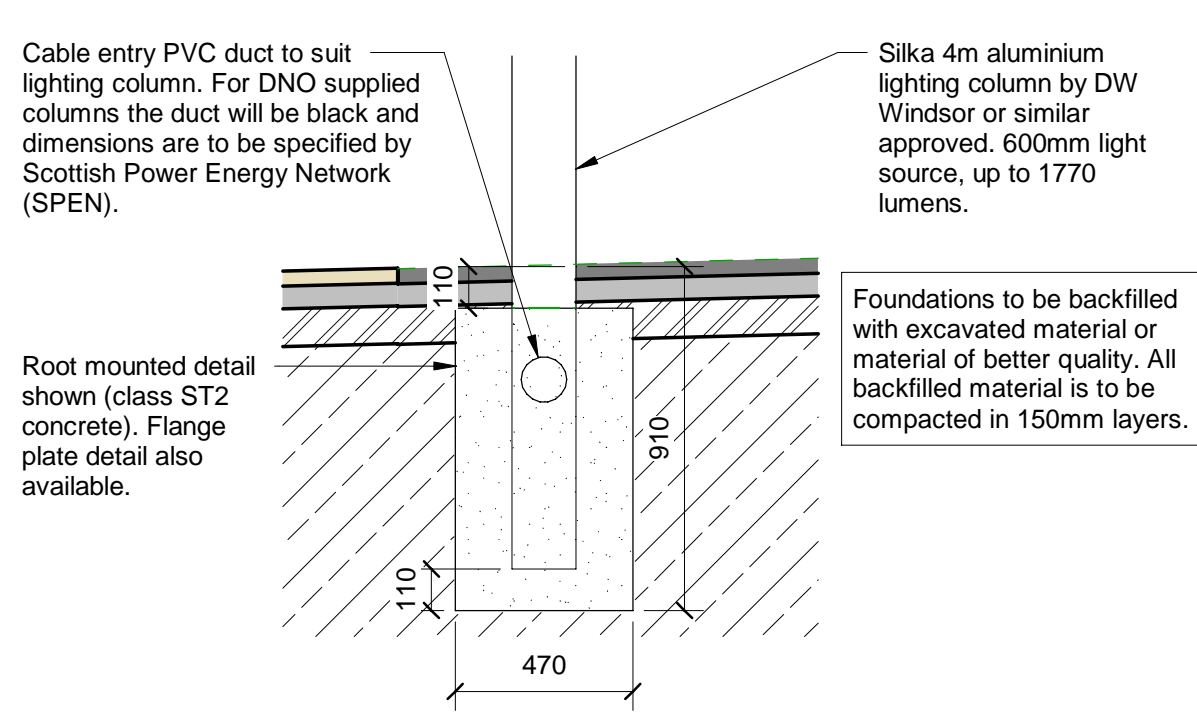

9 Beacon base
1 : 20

See Prom GA plan views for location and types of post & rail restraint systems.

Indicates centre line. Posts to align centrally with top surface of adjoining wall as shown.

Edge restraint as typically 1150mm high, "Harbour" style post & rail system by Marshals or equivalent accepted. Posts fixed at 2m centres to accommodate three rails. Post & rail system to resist class 3 loading (equivalent to a 1.4kN/m horizontal load along the top rails) to BS 7818. Posts & rails to be constructed of "polymer cast" material around a mild steel core and finished with two coats of polyurethane based coating in colour RAL 1013 "Oyster White". Product to provide a minimum 50 year design life in the marine environment.

Safety equipment (lifebuoy & B-line within associated housing) as Guardian™ system by Glasdon or similar accepted shall be mounted on rails at 100m intervals along the seawall, see Plan Views for approximate positions.

Base plate & holding down bolt arrangement to withstand loading requirements for class 3 post & rail pedestrian restraint system as detailed in table 2 of BS 7818-1995. Holding down bolts and domed nuts to be installed from grade A4 stainless steel.

Adjoining concrete wall.
Promenade & reinforcement not shown.

3 Post & rail edge restraint system
1 : 10

Reinforced concrete wall. Reinforcement not shown.

40mm wide movement joint. Wall reinforcement to stop either side of the joint with nominal 75mm concrete cover. Joint filled with high density closed cell polyethylene filler board.

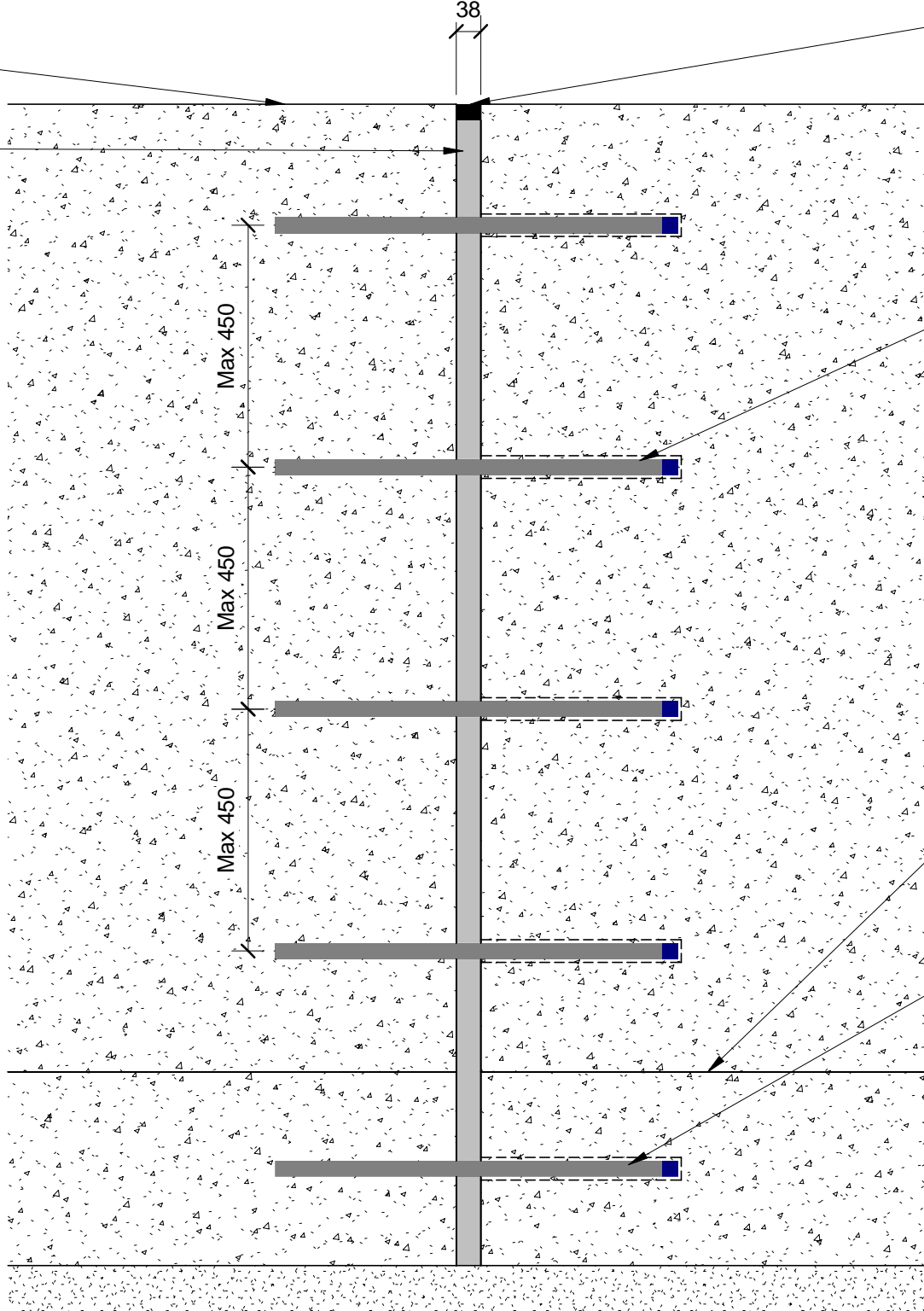

4 Walls movement joints
1 : 10

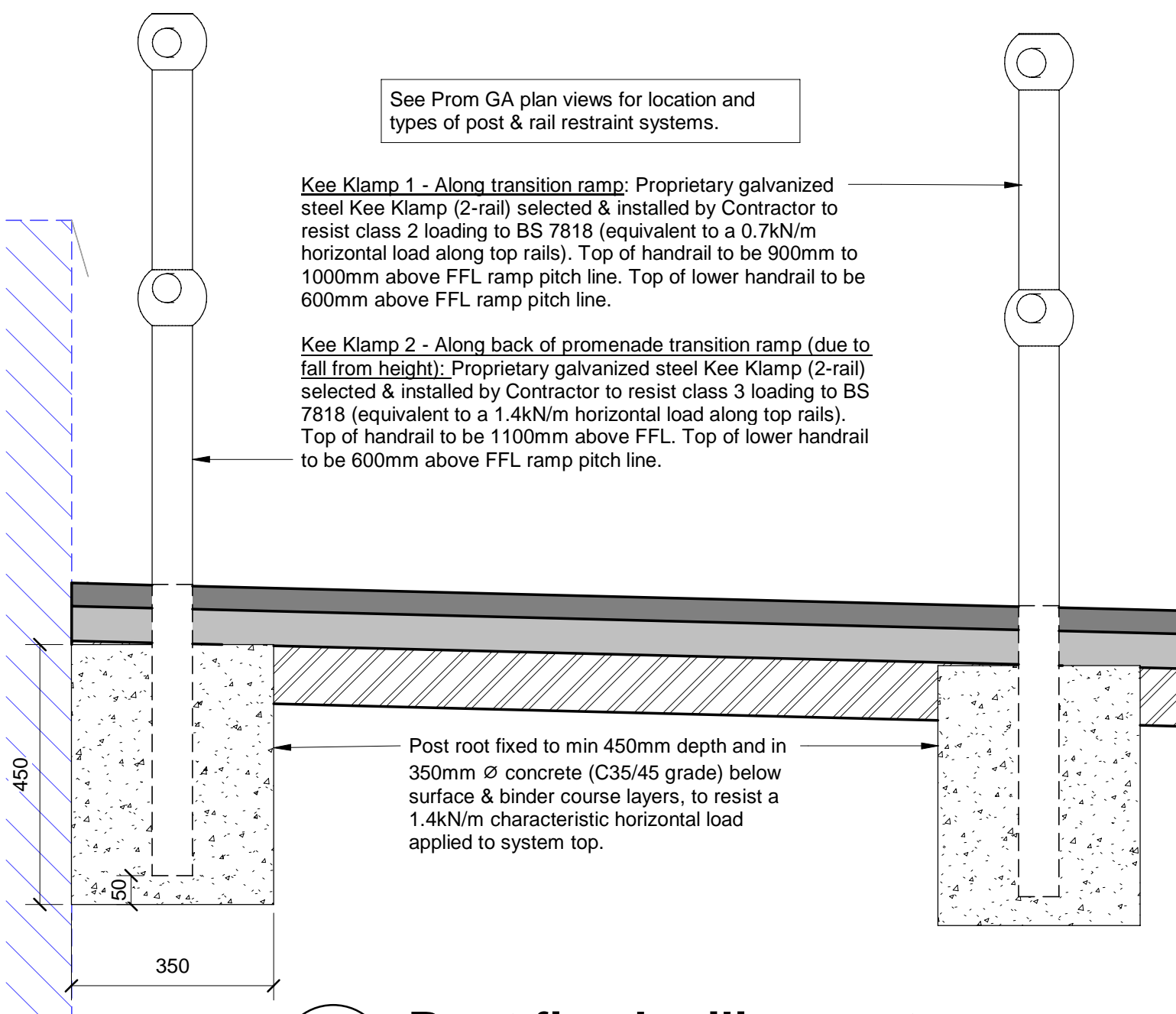

10 Root fixed railing system
1 : 10

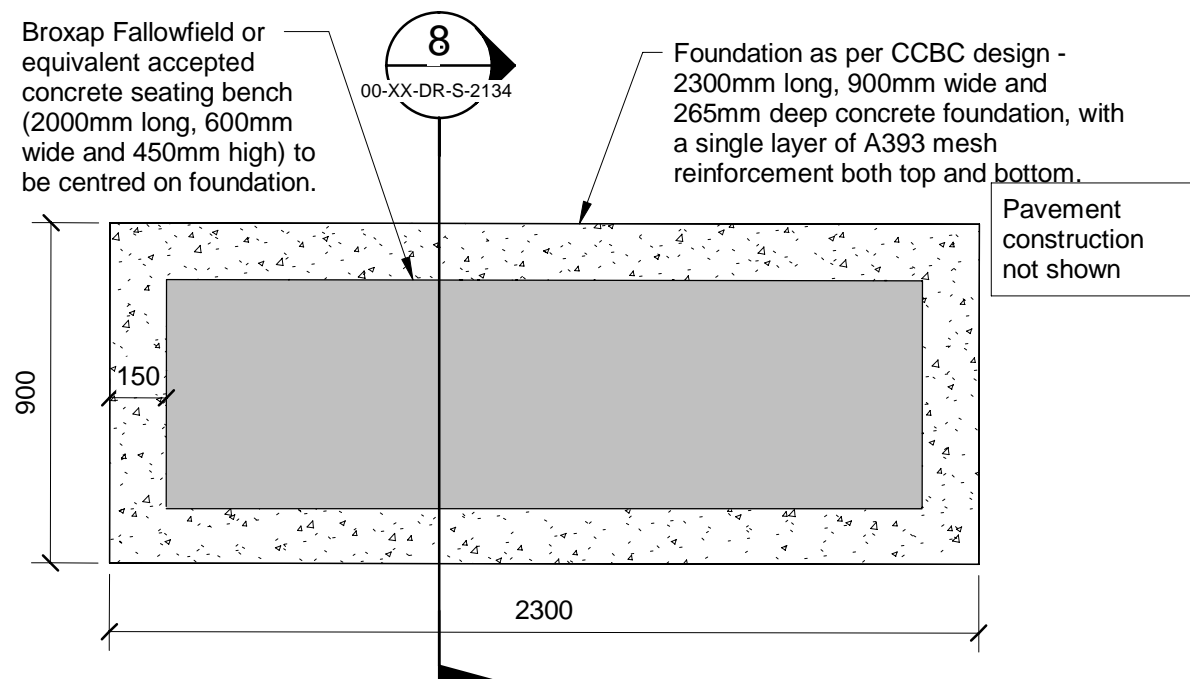

6 Plan view of single bench layout
1 : 20

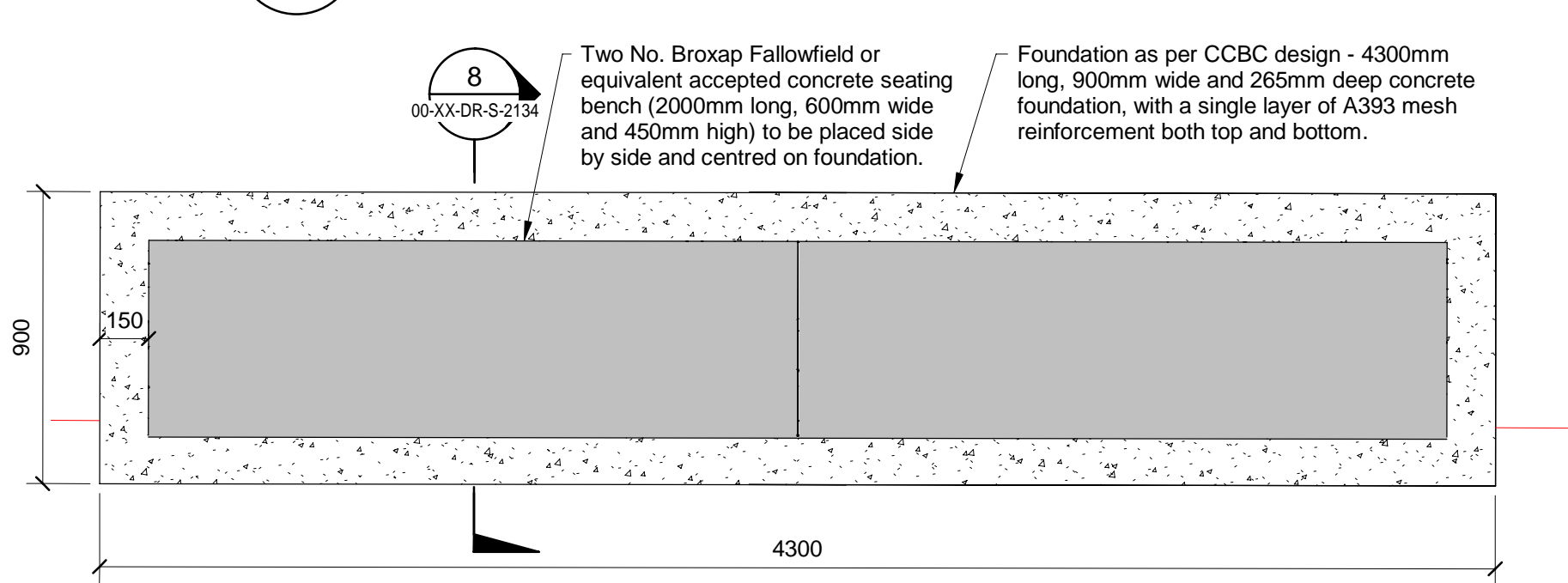

7 Plan view of double bench layout
1 : 20

8 Bench cross section detail
1 : 20

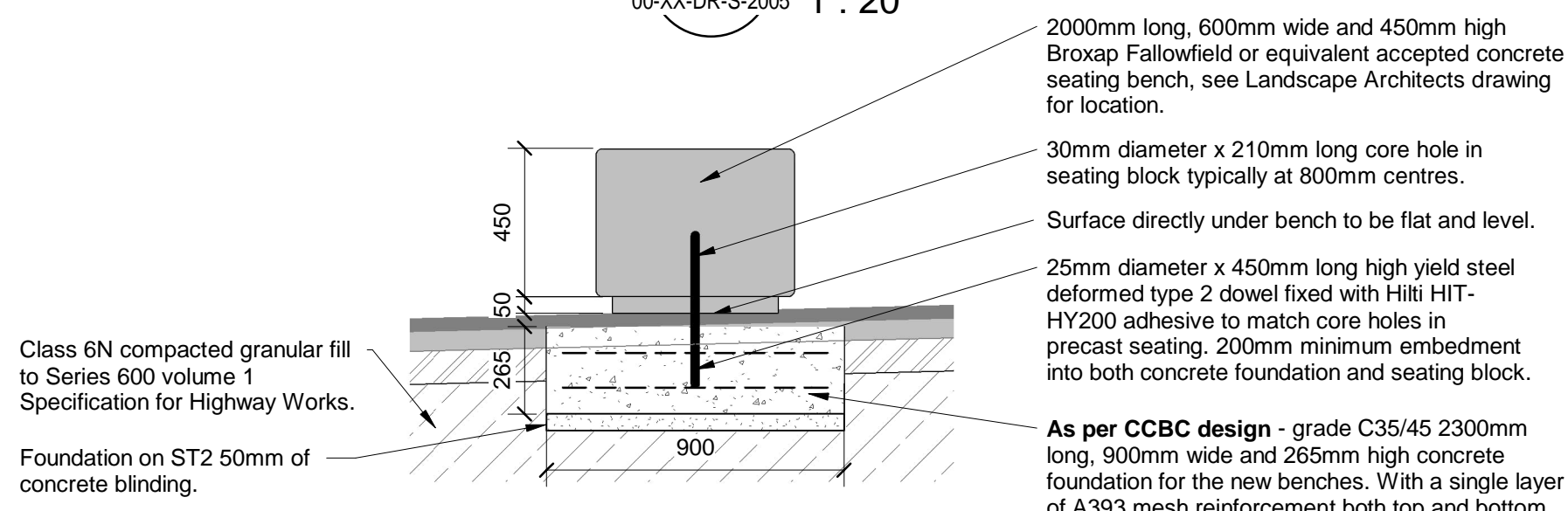

11 Dual Bin - plan view
1 : 20

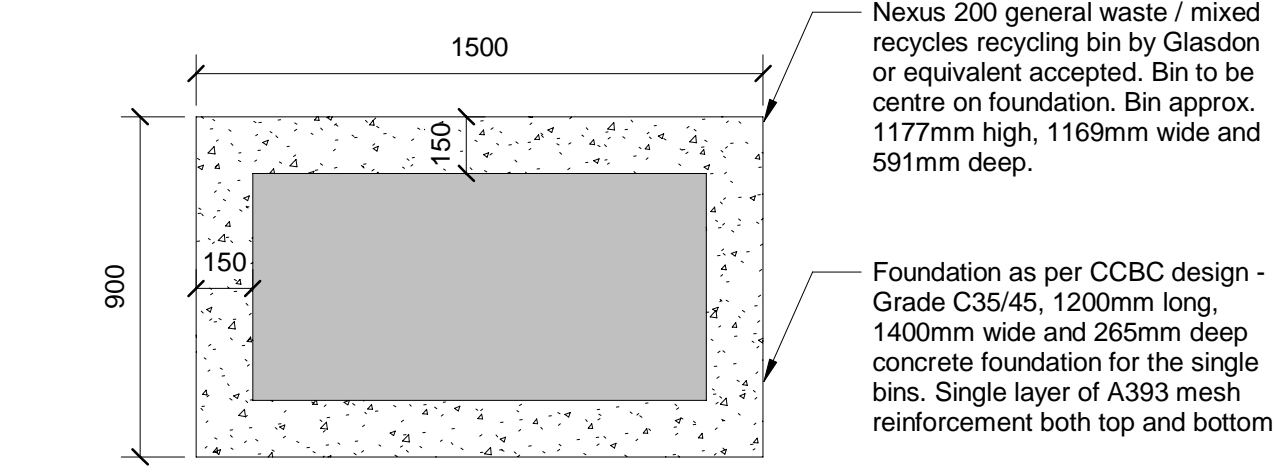

Notes	
1.	For general notes see drawing 415437-MMD-00-XX-DR-S-2030.
2.	Access to all affected in-use manholes draw pits, gullies, inspection chambers etc to be raised; " # " on Plan View denotes possible affected apparatus.
3.	See 415437-MMD-00-XX-DR-C-3500 series of drawings for coastal discipline information.
4.	Top of concrete foundations to be nominally below underside of surface course. Surface directly under bin or bench to be flat and level.
RESIDUAL RISKS:	
<ul style="list-style-type: none">Damage to existing services infrastructure during excavations.Damage to existing seawalls during undertaking seawall repairs, construction of rock revetment, edge restraint installation, raised seawalls, flood door support structure and raised promenade.Unknown ground conditions or obstructions below existing ground. See Foundations Note B1 on dwg 2031 for information.Collapse of structures due to possible voids under the existing prom.Collapse of structures during construction. New RC structures along promenade seaward edge not to be constructed nor the promenade raised until the new rock revetment is constructed to the existing promenade level. Rock revetment to be constructed to rest against the seawall.Working at height, e.g. along promenade seaward edge.	

Key to symbols	
	Existing terrain / structures.
	Proposed reinforced concrete.
	Proposed concrete blinding / mass concrete.
	Class 6N compacted granular fill to Series 600 Volume 1 Specification for Highway Works.
	Class 6N or 6F2 compacted granular fill to Specification for Highway Works.
	Rock revetment

Reference drawings					
415437-MMD-00-XX-DR-S-2030 series for prom general arrangement plans 415437-MMD-00-XX-DR-S-2130 series for prom sections & details					
C02	23.01.2026	RW	Tender Issue - bin updated	GWM	SS
C01	21.01.2026	RW	Tender Issue	GWM	SS
P1	13.01.2026	RW	Tender Issue for Client Acceptance	GWM	SS
Rev	Date	Drawn	Description	Chk'd	App'd
Status Stamp					

Tender Issue	
MOTT MACDONALD	First Floor, Bryn Eirias Abergele Road Colwyn Bay LL29 8BY United Kingdom T +44 (0)1492 534601 W mottmac.com
Client	
 CYNGOR BWRDEISTREF SIROL COUNTY BOROUGH COUNCIL	
Title	

Ph.3 - Old Colwyn Promenade Coastal Defence & Active Travel Improvements PROMENADE SECTIONS & DETAILS					
Designed	R. Williams	Eng. Check	G. Mitchell		
Drawn	R. Williams	Coordination	G. Mitchell		
Dwg. Check	G. Mitchell	Approved	S. Smith		
MMD Project Number	415437	Scale at A1	As indicated	Security	STD
Suitability Description	Tender Issue				Suit. Code A4
Drawing Number	415437-MMD-00-XX-DR-S-2134				Rev C02